

SoundGuard™ Acoustic Panel System

www.roofscreen.com

Updated 03.11.16

SoundGuard™ Acoustic Panel System

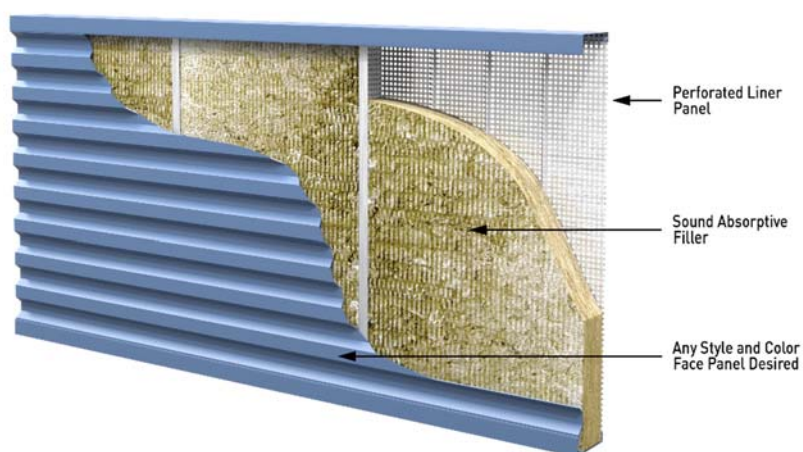

Description:

The SoundGuard™ Acoustic Panel System is a 4" thick sound attenuating barrier assembly designed for aesthetics as well as noise control. The outward facing panels of the system can be any desired material allowing uniformity of color, texture and profile with other elements of the building.

Material:

- Front panel: per customer specification
- Rails and tracks: galvanized 16 ga steel
- Absorptive material: mineral rock wool
- Back panel: perforated stainless steel

Application:

The SoundGuard™ system is engineered for acoustical enclosures and noise barriers where structural integrity, sound absorption and transmission loss are of major concern. SoundGuard™ panels are designed for outdoor applications. This acoustic panel system is engineered to be mounted over open framing such as the RoofScreen framing system or structural steel supports.

Exterior Panel Characteristics:

Panels used for the outward facing surface can be chosen from the entire list of panel types offered by RoofScreen. Face panels sourced elsewhere may also be used if they meet the structural properties required.

PRODUCT DATA SHEET



www.roofscreen.com

SoundGuard™ Acoustic Panel System

Updated 03.11.16

Mineral Rock Wool Specifications:

Mineral Rock Wool conforms to Federal Specifications HH-1-558B and ASTM Standard E-136 and has the following characteristics:

- Has a density of 6 pounds per cubic foot.
- Is non-hygroscopic and absorbs less than 1% water.
- Melts above 2,000 Degrees Fahrenheit, has a flame spread of 15 or less and a smoke development of 0 when tested in accordance with ASTM Standard E-84, is rated incombustible by ASTM Standard E-136.

Acoustical Performance Standards:

Testing results show noise reduction coefficient (NRC) of 1.10 when measured in accordance with the requirements of ASTM C423.

Testing results show sound transmission class (STC) rating of 32 when tested in accordance with the requirements of ASTM E90.

Perforated Panel Characteristics:

Material	Thickness	Hole Size	Hole Shape	Hole Centers	Hole Direction
Stainless Steel	.028"	.125"	Round	.187"	Staggered

Warranty:

When RoofScreen provides project design and engineering calculations, a 20 year limited warranty is included.